

MobileOffice S602

plustek

MobileOffice Series

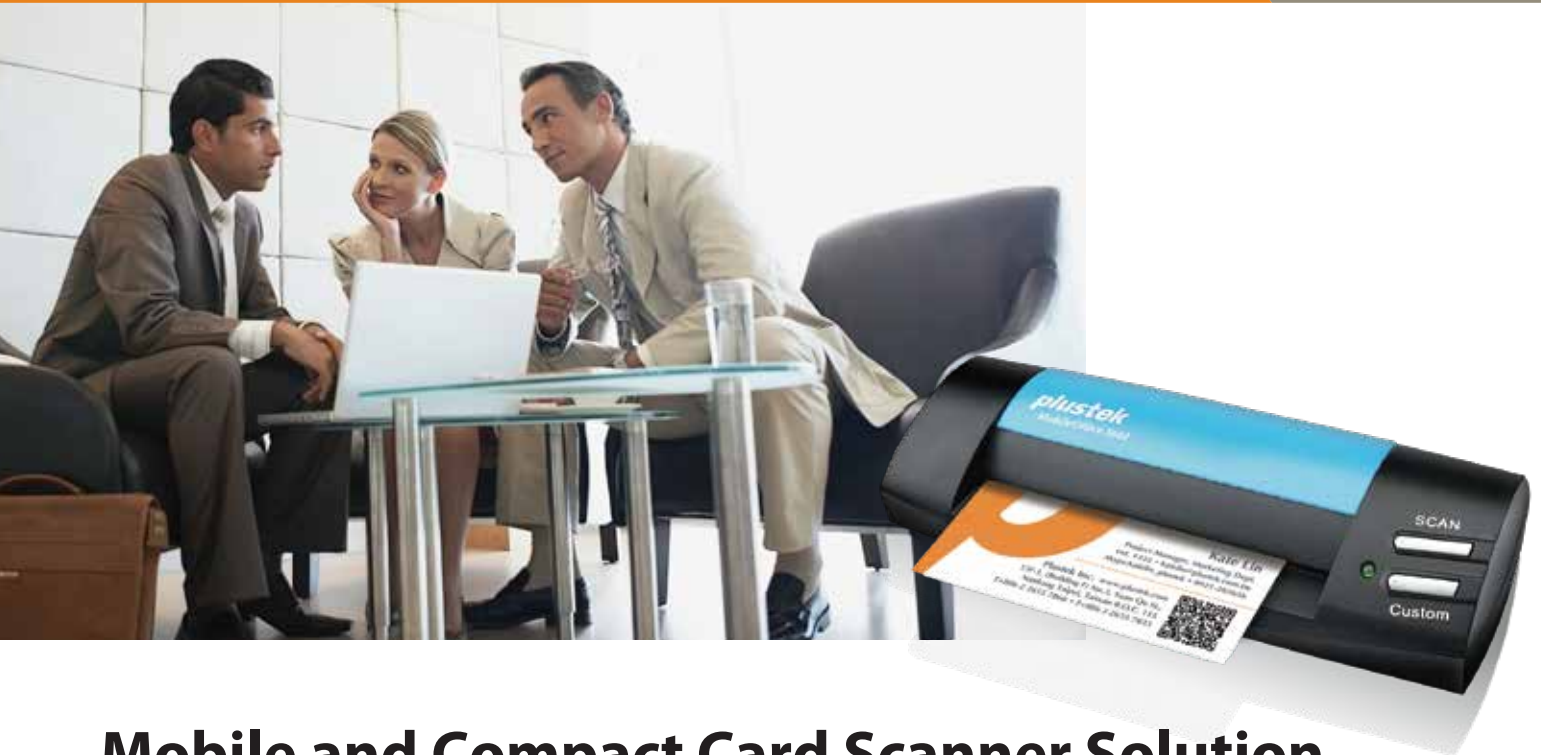

Mobile and Compact Card Scanner Solution



The Plustek MobileOffice S602 is a compact and durable USB-powered card scanner. It scans business cards, driver's licenses, insurance cards, social security cards, membership cards, and unembossed cards. Moreover it scans at up to 1200 x 1200 dpi with fast color and black scan speeds.

The MobileOffice S602 is highly portable mobile scanner that can be slide right into a business bag. It features one-touch scanning to business card recognition software, which can be management your business card and saved to your laptop, and outlook for convenient contact syncing on the go. The bundled software offers character recognition support in more than 183 languages.

By integrating the MobileOffice S602 card scanner into your check-in work flow, you can increase staff productivity and reduce customer wait time. Pre-configured one-touch scanning jobs allow staff to quickly scan information into their existing document management systems, which provides additional security by eliminating print copies of personal documents.

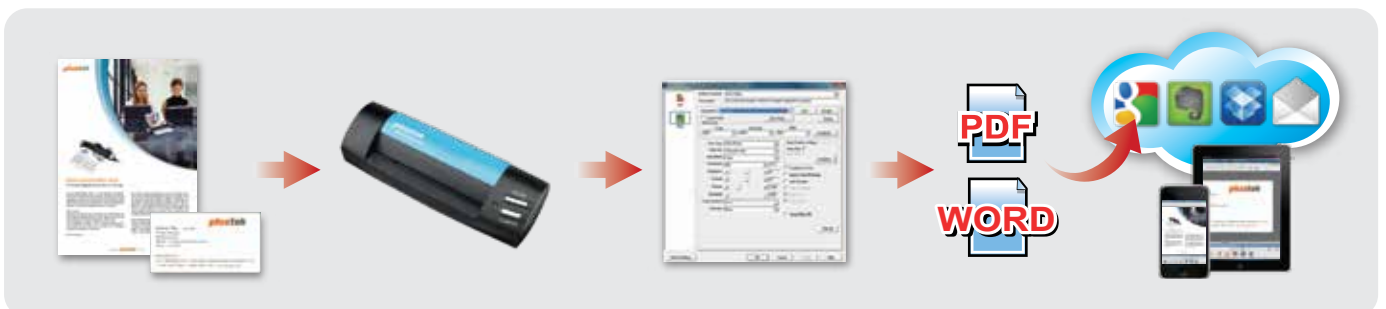

MobileOffice S602

❖ KEY FEATURES



Perfect Mobility

The MobileOffice S602 is lightweight, compact and easy to carry and ideal for the desktop or on-the-go. Also, with the USB-powered system, it can easily connect with a laptop via USB connection.



Professional Business Card Organizer

With the comprehensive BCR (Business Card Recognition) software, the MobileOffice S602 digitalizes and organizes business cards with ease. Users can easily synchronize their contacts for further use.

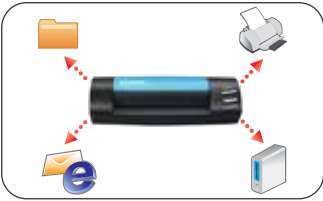

Scan to Multiple Destinations

The MobileOffice S602 can be connected to destination such as FTP or Mail, making them instantly available to upload the file.



Made for Integration

The MobileOffice S602 comes with TWAIN and WIA drivers that ensure the compatibility with various document management systems and provides a cost effective way to capture customer information.

Hardware Requirements

2.0 GHz CPU processor or higher[1]
 [1] Windows Recommended: 2.8 GHz Intel® Core™ i5 Processor with 4 CPU Cores or higher
 4 GB RAM minimum (Recommended: 8 GB or more)
 6 GB of hard-disk space for program installation
 Display dimensions of 1024x768 or greater

Software



Specification

Light Source	LED
Image Sensor	CIS
Optical Resolution	1200 dpi
Scan Modes	Color: 48-bit Input; 24-bit Output Grayscale: 16-bit Input; 8-bit Output B/W: 1-bit Output
Scanning Speed	5.5 Seconds (Color, 300 dpi, A6)
Scanning Area (W x L)	Maximum: 104.9 x 500 mm (4.13" x 19.69") Minimum: 33 x 43 mm (1.3" x 1.7") TWAIN support 104.9 x 500 mm (4.13" x 19.69")
Interface	USB 2.0
Power Supply	USB bus power , 5V , 500 mA
Net Weight	0.19 Kgs (0.42 Lbs)
Dimensions (W x D x H)	174.5 x 60.5 x 38.5 mm (6.87" x 2.38" x 1.52")
OS	Windows 7 / 8 / 10 / 11 Linux ^[2]



[1] ABBY™ FineReader™ © ABBY. OCR by ABBY. ABBY and FineReader are trademarks of ABBY Software, Ltd. which may be registered in some jurisdictions. Any other products or company names appearing in this document are the trademarks or registered trademarks of the respective companies.

[2] Linux compatibility is only available for system integrators. Please contact sales@plustek.com for more info.